



Technical Characteristics

- Aluminum alloy construction
- Smooth operation
- Maintenance free

Electric Motor

- IE3 Wide Range cURus Motors
- IP55 protection rating, class F insulation, suitable for operating with inverter
- Thermal Protector (PTO) as standard

Options

- Special voltages (IEC 60038)
- Surface treatments
- Increased seal version

~3	[V] (Y / Δ)	[Hz]
IE3	400 / 230	50
	460 / 265	60
Wide Range	345 - 415 / 200 - 240	50
	380 - 480 / 220 - 280	60

Supply voltage - Tolerance on the fixed voltage value $\pm 10\%$, in range $\pm 5\%$.

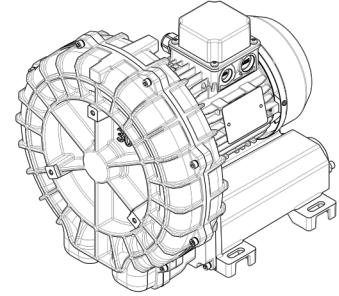

Performance Table

P _n [kW]	Frequency [Hz]	Δp _{max} [mbar]		Q _{max} [m³/h]	Leq ¹ [dB(A)]	Weight [kg]	H ² [mm]	Current Consumption (Y/Δ) [A]		Cosφ [-]	Speed [rpm]
		Suction	Compression					IE3	Range		
1.1	50	300	325	91	70	27	350	2.33 / 4.04	2.56-2.32 / 4.43-4.02	0.82	2880
1.3	60	325	300	110	73	27	350	2.32 / 4.02	2.69-2.30 / 4.66-3.98	0.84	3475
1.5	50	350	425	91	70	30	350	3.14 / 5.44	3.40-3.16 / 5.89-5.47	0.82	2880
1.7	60	375	425	110	73	30	350	3.02 / 5.23	3.52-3.03 / 6.10-5.25	0.84	3470

1. Noise level measured at a distance of 1 m with ducted intake and delivery, in accordance with Standard ISO 3744.
2. See figure "dimensions" at following page.

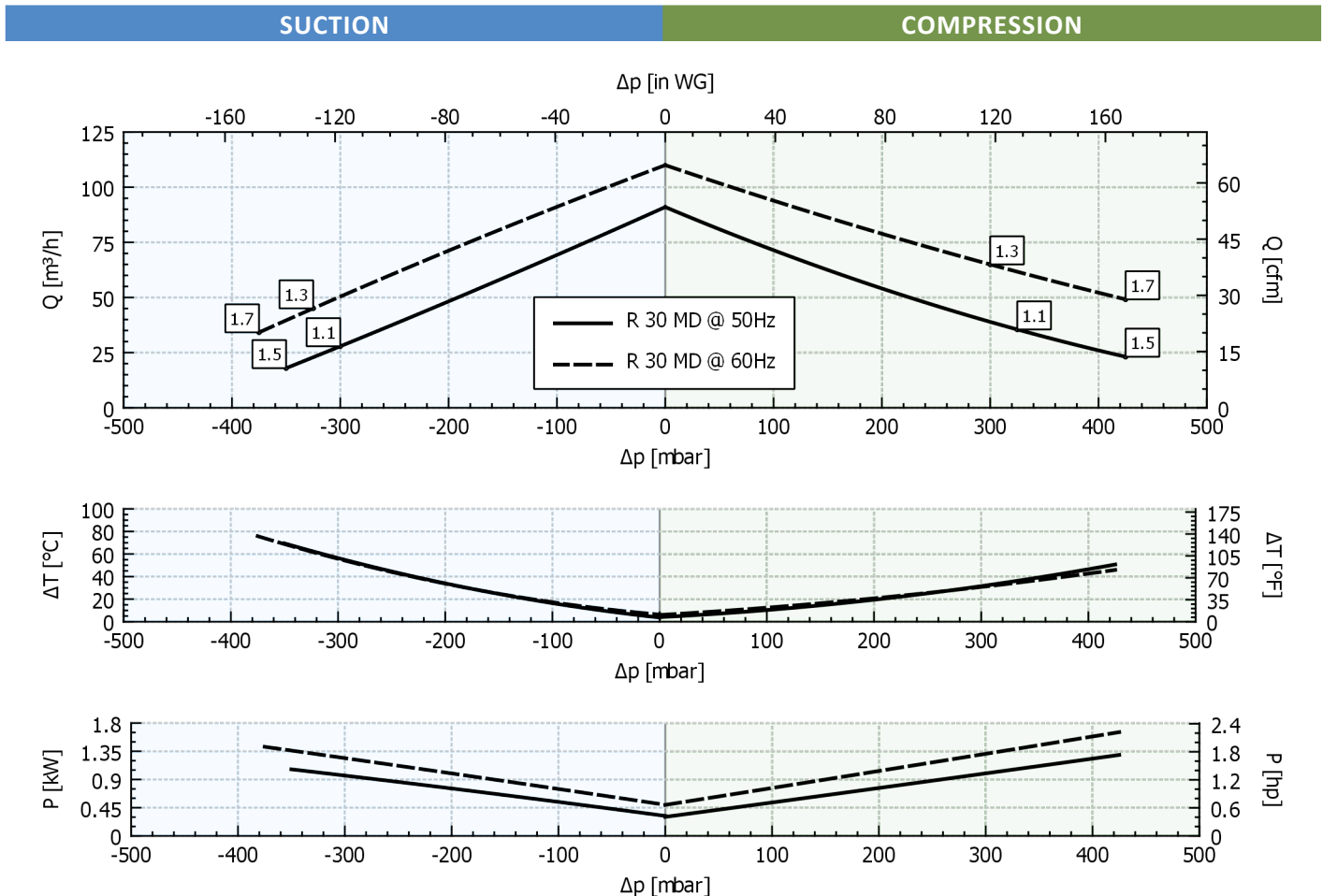

Tolerance on indicated values $\pm 10\%$.
Data subject to change without notice.
Curves referring to air at a temperature of 20 °C and atmospheric pressure of 1013 mbar (abs).

Dimensions

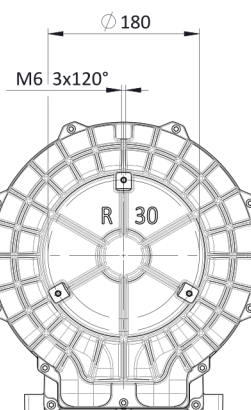
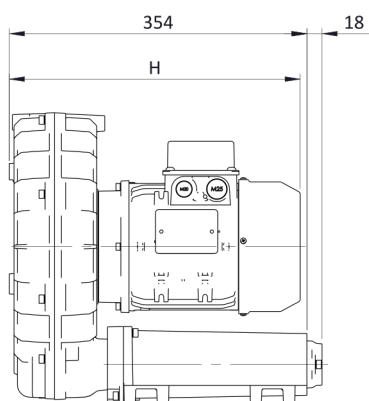
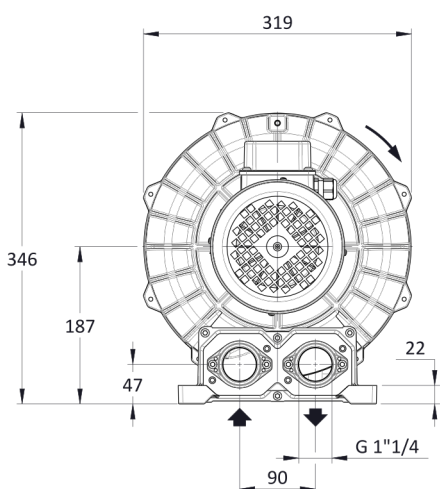
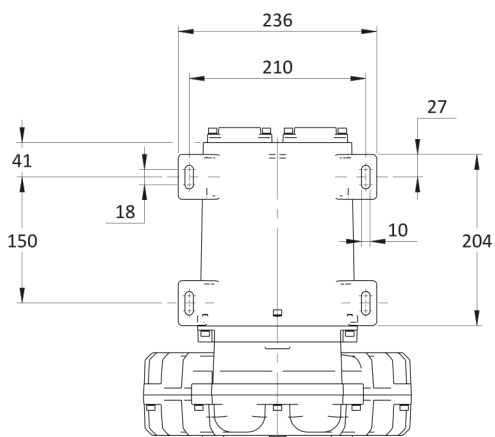

Dimensions in mm
NOT Binding

INSTALLATION

- For proper operation of the machine, it must be provided with a suction FILTER and a vacuum/pressure limiting VALVE.
- Other accessories are available on request.
- Permissible ambient and fluid temperature in suction from -15 °C to +40 °C.
- Read the instruction manual carefully before installing the machine.